

PARKING REQUIREMENTS
 PROPOSED DRIVE-UP/DRIVE-IN/20-18 STREET TREES REQUIRED
 STREET TREES=1600-1800 SQUARES REQUIRED
 NEW PARKING SPACES=24/710 = 4 NEW PARKING LOT TREES
 IF THERE ARE EXISTING TREES EXCEEDING 4" IN DIAMETER, THEY
 WILL BE CREDITED.

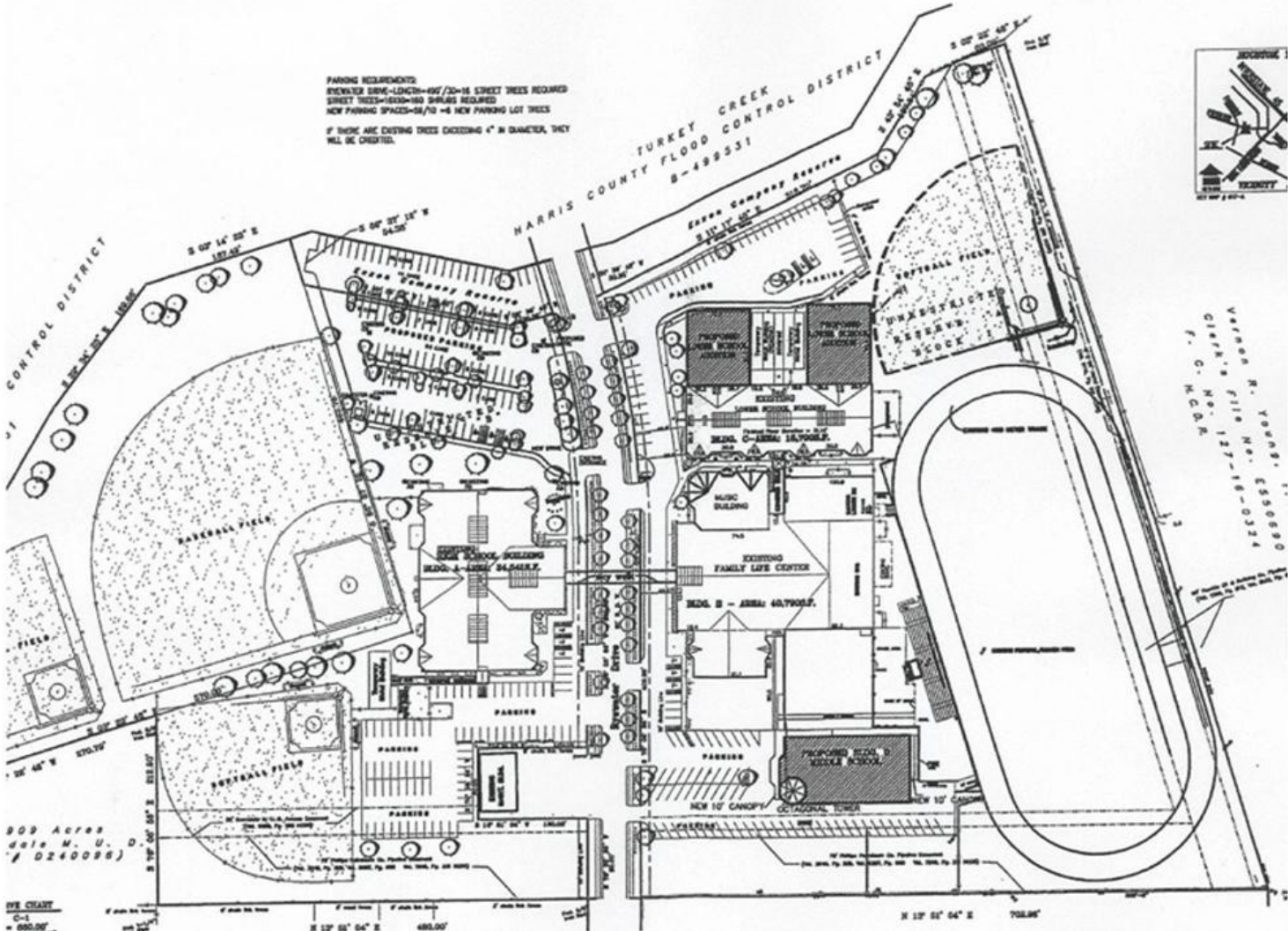

VERSION R. 10/08/11
 CLIENT'S FILE NO. 550090
 CLIENT'S FILE NO. 17-18-0314
 F. C. H.C.R.

809 Acres
 date M. U. D.
 (024098)

- KEY CHART**
- C-1
 - = 500.00'
 - = 15°47'51"
 - = 207.00'
 - 24°40' E 208.87'
- C-2
- = 500.00'
 - = 15°47'51"
 - = 240.31'
 - 22°28' W 238.45'

Scarsdale Subdivision
 Section One
 Vol. 161, Pg. 39 H.C.M.R.

Scarsdale Subdivision
 Section Three
 Vol. 188, Pg. 78 H.C.M.R.



**LUTHERAN SOUTH ACADEMY
 MASTER SITE PLAN**

Scale 1"=50'

KEY MAP
 NO. 617-A

LEGAL DESCRIPTION
 SURVEY OF A 10.784 ACRE AND A 4.825 ACRE
 TRACT OF LAND OUT OF THE AUGUST WHITLOCK
 SURVEY, A-795, HARRIS COUNTY, TEXAS